

# Reducing Tee

Stainless Grade 316

## Features

- Standard AS: 1528.3
- Other sizes up to 12" (304.8mm) available. Refer to Spiral Weld products

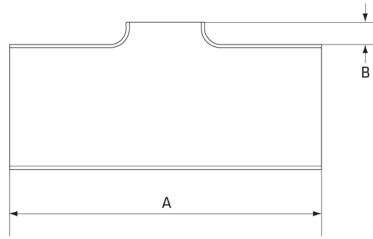

## Dimensions

Unit: mm (unless stated otherwise)

Size	2 1/2 - 2" 63.5 - 50.8	3 - 1" 76.2 - 25.4	3 - 1 1/2" 76.2 - 38.1	3 - 2" 76.2 - 50.8	3 - 2 1/2" 76.5 - 63.5	4 - 1" 101.6 - 25.4	4 - 1 1/2" 101.6 - 38.1
A	190.5	228.6	228.6	228.6	228.6	304.8	304.8
B	3	3	3	3	3	3	3
Thickness	1.6	1.6	1.6	1.6	1.6	1.6	1.6
Code	STRT66550	STRT67525	STRT67540	STRT67550	STRT67565	STRT610025	STRT610040
Size	4 - 2" 101.6 - 50.8	4 - 2 1/2" 101.6 - 63.5	4 - 3" 101.6 - 76.2	5 - 4" 127 - 101.6	6 - 4" 152.4 - 101.6	6 - 5" 152.4 - 127	6 - 2" 152.4 - 50.8
A	304.8	304.8	304.8	381	457.2	457.2	457.2
B	3	3	3	3	3	3	3
Thickness	1.6	1.6	1.6	2	2	2	2
Code	STRT610050	STRT610065	STRT610075	STRT6125100	STRT6150100	STRT6150125	STRT615050
Size	6 - 3" 152.4 - 76.2	8 - 4" 203.2 ID - 101.6	8 - 6" 203.2 ID - 152.4	10 - 6" 254 ID - 152.4	12 - 10" 304.8 ID - 254	1 1/4 - 1" 31.8-25.4	1 1/2 - 1" 38.1-25.4
A	457.2	395	395	495	595	88	114.3
B	3	3	3	3	3	3	3
Thickness	2	2	2	2	3	1.6	1.6
Code	STRT615075	SSWRT4200100	SSWRT4200150	SSWRT4250150	SSWRT4300250	STRT63025	STRT64025



Size	1 1/2 - 1 1/4" 38.1-31.8	2 - 1" 50.8-25.4	2 - 1 1/4" 50.8-31.8	2 - 1 1/2" 50.8-38.1	2 1/2 - 1" 63.5-25.4	2 1/2 - 1 1/2" 63.5-38.1
<b>A</b>	100	152.4	124	152.4	190.5	150
<b>B</b>	2	3	4	3	3	6
<b>Thickness</b>	1.6	1.6	1.6	1.6	1.6	1.6
<b>Code</b>	STR64030	STR65025	STR65030	STR65040	STR66525	STR66540

