

# Sanitary Ball Valve

## Features

- Butt welds to Outside Diameter tube sizes
- Multi-position handle
- Maximum working temperature 120°C (with EPDM seal)

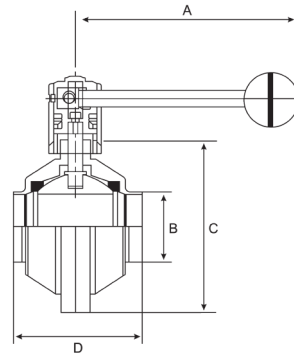

Unit: mm (unless stated otherwise)

## Dimensions

Size	2" 50.8	3" 76.2	4" 101.6
<b>A</b>	143	186	215
<b>B</b>	50.8	76.2	101.6
<b>C</b>	125	170	212
<b>D</b>	110	135	170
<b>Code</b>	SSBV50	SSBV75	SSBV100

