

# Medium Tube Bend 45°

Stainless Grade 304 and 316

## Features

- From 1/2" - 6": Medium Bend (UNI), 320 Grit - satin finish, Standard AS: 1528.3
- From 8" - 16": Standard Bend, mill finish, sizes to suit Spiral Weld Tube

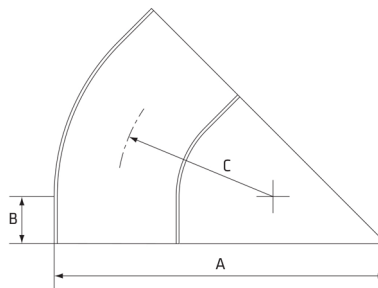

## Dimensions

Unit: mm (unless stated otherwise)

Size	3/4" 19.05	1" 25.4	1" 25.4	1 1/4" 31.8	1 1/4" 31.8	1 1/2" 38.1	1 1/2" 38.1
<b>A</b>	110.5	123	123	136	136	148	148
<b>B</b>	30	30	30	30	30	30	30
<b>C</b>	28.65	38.1	38.1	47.6	47.6	57.2	57.2
<b>Thickness</b>	1.6	1.6	1.6	1.6	1.6	1.6	1.6
<b>Code</b>	STB42045	STB42545	STB62545	STB43045	STB63045	STB44045	STB64045

Size	2" 50.8	2" 50.8	2 1/2" 63.5	2 1/2" 63.5	3" 76.2	3" 76.2	4" 101.6
<b>A</b>	174	174	199	199	225	225	275
<b>B</b>	30	30	30	30	30	30	30
<b>C</b>	76.2	76.2	95.3	95.3	114.3	114.3	152.4
<b>Thickness</b>	1.6	1.6	1.6	1.6	1.6	1.6	1.6
<b>Code</b>	STB45045	STB65045	STB46545	STB66545	STB47545	STB67545	STB410045

Size	4" 101.6	5" 127	6" 152.4	6" 152.4	8" 203	8" 203.2 ID	8" 203.20 OD
<b>A</b>	275	350.6	401.4	401.4	N/A	207.2	N/A
<b>B</b>	30	40	40	40	N/A	408.6	N/A
<b>C</b>	152.4	190.5	228.6	228.6	N/A	203.2	N/A
<b>Thickness</b>	1.6	2.0	2	2	2.0	2	2.0
<b>Code</b>	STB610045	STB412545	STB415045	STB615045	STB620045	SSWB420045	STB420045



Size	10" 254 ID	10" 254 ID	12" 304.8 ID
<b>A</b>	258	260	310.8
<b>B</b>	510	511	612.4
<b>C</b>	254	254	304.8
<b>Thickness</b>	2	3	3
<b>Code</b>	SSWB425045	SSWB42504530	SSWB430045

