

Tri Clover Tee

Stainless Grade 304

Features

- 320 Grit - satin finish
- No need for welding! Save time and effort with pre-ferruled fittings

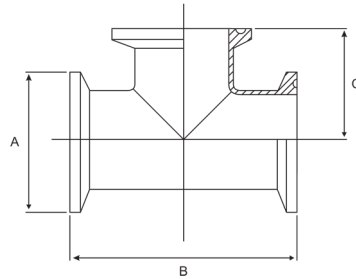

Dimensions

Unit: mm (unless stated otherwise)

Size	1" 25.4	1 1/2" 38.1	2" 50.8	2 1/2" 63.5	3" 76.2	4" 101.6
A	50.5	50.5	64	77.5	91.0	119
B	120.6	139.8	177.8	177.8	190.6	228.4
C	60.3	69.9	88.9	88.9	95.3	114.2
Code	STETFER25	STETFER40	STETFER50	STETFER65	STETFER75	STETFER100

