

Plain Tube Clamp

Features

- To suit Outside Diameter tube
- Includes stainless fasteners (Metric)

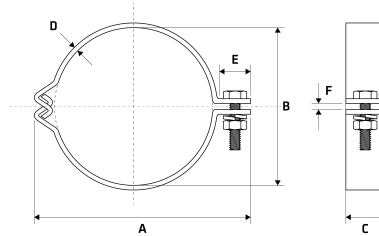

Dimensions

Unit: mm (unless stated otherwise)

Size	1" 25.4	1 1/4" 31.8	1 1/2" 38.1	2" 50.8	2 1/2" 63.5	3" 76.2	4" 101.6
A	58	64.6	72.9	85.8	98.7	114.5	137
B	25.4	31.8	38.1	50.8	63.5	76.2	101.6
C	25	25	25	25	25	25	25
D	3	3	3	3	3	3	3
E	20	20	20	20	20	20	20
F	4	4	4	4	4	4	4
Code	SPTC25	SPTC30	SPTC40	SPTC50	SPTC65	SPTC75	SPTC100

