

Bossed Pipe Clamp

Features

- To suit Nominal Bore pipe
- M10 threaded boss (17mm long)
- Includes stainless fasteners (Metric)

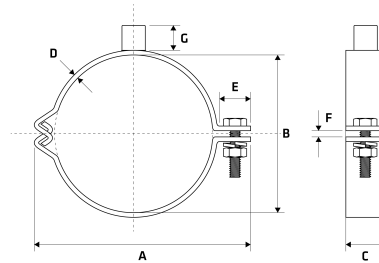

Dimensions

Unit: mm (unless stated otherwise)

Size	3/4" 20NB	1" 25NB	1 1/4" 32NB	1 1/2" 40NB	2" 50NB	2 1/2" 65NB	3" 80NB
A	59.3	66.3	77	83.2	95.5	108.3	124.2
B	26.67	33.4	42.16	48.26	60.33	73.03	88.9
C	25	25	25	25	25	25	25
D	3	3	3	3	3	3	3
E	20	20	20	20	20	20	20
F	4	4	4	4	4	4	4
G	17	17	17	17	17	17	17
Code	SBPC20	SBPC25	SBPC32	SBPC40	SBPC50	SBPC65	SBPC80



Size	4" 100NB
A	149.7
B	114.3
C	25
D	3
E	20
F	4
G	17
Code	SBPC100

