

# Bossed Tube Clamp

## Features

- To suit Outside Diameter tube
- M10 threaded boss (17mm long)
- Includes stainless fasteners (Metric)

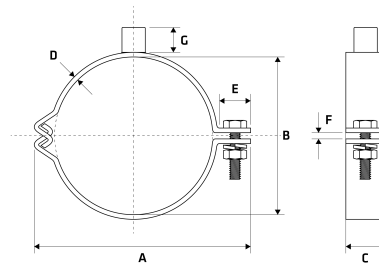

## Dimensions

Unit: mm (unless stated otherwise)

Size	1" 25.4	1 1/4" 31.8	1 1/2" 38.1	2" 50.8	2 1/2" 63.5	3" 76.2	4" 101.6
<b>A</b>	58	64.6	72.9	85.8	98.7	114.5	137
<b>B</b>	25.4	31.8	38.1	50.8	63.5	76.2	101.6
<b>C</b>	25	25	25	25	25	25	25
<b>D</b>	3	3	3	3	3	3	3
<b>E</b>	20	20	20	20	20	20	20
<b>F</b>	4	4	4	4	4	4	4
<b>G</b>	17	17	17	17	17	17	17
<b>Code</b>	SBTC25	SBTC30	SBTC40	SBTC50	SBTC65	SBTC75	SBTC100

