

# Pressed End Cap

Stainless Steel Grade 316

## Features

- Butt welds to Outside Diameter tube sizes

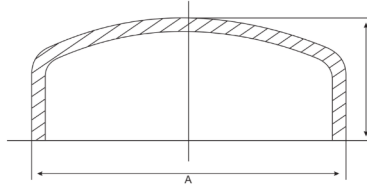

## Dimensions

Unit: mm (unless stated otherwise)

Size	1" 25.4	1 1/2" 38.1	2" 50.8	2 1/2" 63.5	3" 76.2	4" 101.6	6" 152.4
<b>A</b>	25.4	38.1	50.8	63.5	76.2	101.6	152.4
<b>B</b>	11.5	14	17	17.5	26	25	37
<b>Thickness</b>	1.6	1.6	1.6	1.6	1.6	1.6	2
<b>Weight kg/mtr</b>							
<b>Code</b>	STPEC625	STPEC640	STPEC650	STPEC665	STPEC675	STPEC6100	STPEC6150

Size	8" 203.2ID	10" 254ID	12" 304.8ID
<b>A</b>	208	258	308
<b>B</b>	42	52	61
<b>Thickness</b>	2	2	2
<b>Weight kg/mtr</b>	0.713	1.056	1.434
<b>Code</b>	SSWPEC6200	SSWPEC6250	SSWPEC6300

