

# NPT-BSP Hex Nipple Adapter

## Features

- BSP/NPT Threaded Ends
- 150lbs Pressure Rating
- Threads are Tapered (BSPT/NPT)
- NPT thread conforms with ASME B1.20.1 and the BSP thread conforms with ISO 7-1/ISO 228-1

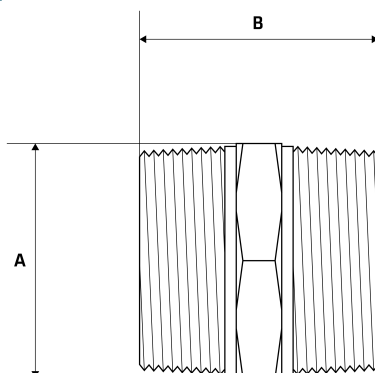

## Dimensions

Unit: mm (unless stated otherwise)

Size	1/4" 8NB	3/8" 10NB	1/2" 15NB	3/4" 20NB	1" 25NB	1 1/4" 32NB	1 1/2" 40NB
<b>A</b>	14.5	17.5	21.5	27.5	34	42.5	49
<b>B</b>	29	29.5	35	39	44	49.5	49.5
<b>Code</b>	NPTBSPHN08	NPTBSPHN10	NPTBSPHN15	NPTBSPHN20	NPTBSPHN25	NPTBSPHN32	NPTBSPHN40

Size	2" 50NB
<b>A</b>	61
<b>B</b>	58.5
<b>Code</b>	NPTBSPHN50

