

NPT Socket

Features

- NPT Threaded Ends
- Working Pressure: 150lbs (psi) / 10bar
- Working Temperature: 250°C at 10bar
- Investment lost wax casting manufactured to ISO 9001 : 2015
- Thread ends conform to DIN 2999 & 150 228/1
- Threads are Tapered (NPTT)

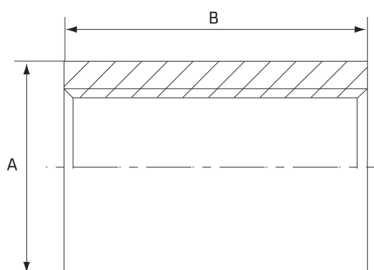

Dimensions

Unit: mm (unless stated otherwise)

Size	1/4" 8NB	3/8" 10NB	1/2" 15NB	3/4" 20NB	1" 25NB	1 1/4" 32NB	1 1/2" 40NB
A	18	21	25	31.4	37	46.5	52.5
B	24.5	26	33	35	42	45	45
Code	NPTS08	NPTS10	NPTS15	NPTS20	NPTS25	NPTS32	NPTS40

Size	2" 50NB	2 1/2" 65NB	3" 80NB	4" 100NB
A	65.1	81.5	95	122
B	54.5	63.5	68.5	76.5
Code	NPTS50	NPTS65	NPTS80	NPTS100

