

BSP 2pc Ball Valve

Features

- BSP threaded ends
- Maximum pressure 1000PSI / 69Bar W.O.G. (Water, Oil, Gas)
- PTFE seal maximum temperature 160°C
- Full port
- Lockable latch handle
- Red handle sleeve available for hot water indication

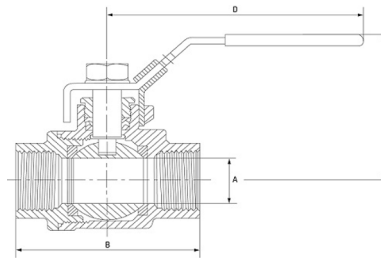

Dimensions

Unit: mm (unless stated otherwise)

Size	1/4" 8NB	3/8" 10NB	1/2" 15NB	3/4" 20NB	1" 25NB	1 1/4" 32NB	1 1/2" 40NB
A	11.6	12.7	15	20	25	32	40
B	49	49	60	65	80.3	93.4	105
C	48	48	58.3	56	71.9	77.6	86.3
D	95	95	105	110	125	125	144
Code	SBV208	SBV210	SBV215	SBV220	SBV225	SBV232	SBV240

Size	2" 50NB	2 1/2" 65NB	3" 80NB
A	50	65	80
B	116	160	168.5
C	94.5	124	134.5
D	144	215	243
Code	SBV250	SBV265	SBV280

