

NPT Hex Bush

Features

- NPT Threaded Ends
- Working Pressure: 150lbs (psi) / 10bar
- Working Temperature: 250°C at 10bar
- Investment lost wax casting manufactured to ISO 9001 : 2015
- NPT thread conforms with ASME B1.20.1
- Threads are Tapered NPT

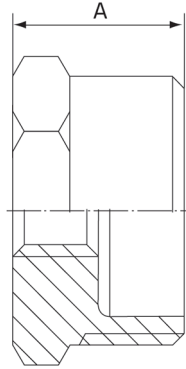

Dimensions

Unit: mm (unless stated otherwise)

Size	3/8"x1/4" 10NBx8NB	1/2"x1/8" 15NBx6NB	1/2"x3/8" 15NBx10NB	3/4"x1/2" 20NBx15NB	1"x1/2" 25NBx15NB	1"x3/4" 25NBx20NB	1 1/4"x1" 32NBx25NB
A	18	22	22.4	22	29	29	31.2
Code	NPTB1008	NPTB1506	NPTB1510	NPTB2015	NPTB2515	NPTB2520	NPTB3225

Size	1 1/2"x1" 40NBx25NB	1 1/2"x1 1/4" 40NBx32NB	2"x1" 50NBx25NB	2"x1 1/2" 50NBx40NB
A	31.5	31.5	35.3	35.3
Code	NPTB4025	NPTB4032	NPTB5025	NPTB5040

