

Tri Clover Clamp

Stainless Grade 304

Features

- Single pin, heavy duty clamp

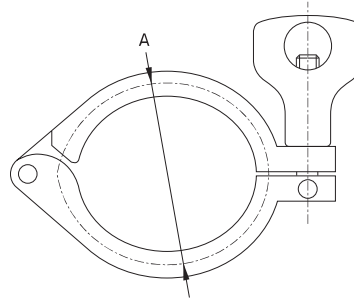

Dimensions

Unit: mm (unless stated otherwise)

The Metal Company Ltd

Size	12.7 - 19.05 1/2 - 3/4"	25.4 - 38.1 1 - 1 1/2"	50.8 2"	63.5 2 1/2"	76.2 3"
A	37	53.9	67.4	80.9	94.4
Code	TRICLP1220	TRICLP2540	TRICLP50	TRICLP65	TRICLP75

Size	101.6 4"	127 5"	152.4 6"	203.2 8"
A	122.4	147.8	170.4	221.2
Code	TRICLP100	TRICLP125	TRICLP150	TRICLP200

Tri Clover Blank

Stainless Grade 316

Features

- Used for blanking the union

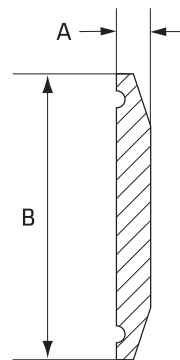

Dimensions

Unit: mm (unless stated otherwise)

Size	12.7 - 19.05 1/2 - 3/4"	25.4 - 38.1 1 - 1 1/2"	50.8 2"	63.5 2 1/2"	76.2 3"
A	5	6.3	6.3	6.3	6.3
B	25.5	50.5	64	77.5	91
Code	TRIUB12	TRIUB20	TRIUB50	TRIUB65	TRIUB75

Size	101.6 4"	127 5"	152.4 6"	203.2 8"
A	7.9	7.9	11.1	11.1
B	119	144	166.8	217.7
Code	TRIUB100	TRIUB125	TRIUB150	TRIUB200