

Tri Clover Seal

EPDM / Viton

Features

- EPDM seal temperature rating 120°C
- Viton seal temperature rating 230°C
- EPDM is suitable for general insulation of hot water, steam, alcohols, coolants, acids and bases
- Viton is suitable for higher temperatures and restricting permeation of chemicals



Dimensions

Unit: mm (unless stated otherwise)

Size	12.7 1/2"	19.05 3/4"	25.4 1"	31.8 1 1/4"	38.1 1 1/2"	50.8 2"
Code(EPDM)	TRISS12	TRISS20	TRISS25	TRISS30	TRISS40	TRISS50
Code (Viton)	TRISS12V	TRISS20V	TRISS25V	TRISS30V	TRISS40V	TRISS50V

Size	63.5 2 1/2"	76.2 3"	101.6 4"	127 5"	152.4 6"	203.2 8"
Code (EPDM)	TRISS65	TRISS75	TRISS100	TRISS125	TRISS150	TRISS200
Code (Viton)	TRISS65V	TRISS75V	TRISS100V	TRISS125V	TRISS150V	TRISS200V

BSP Nipple to Tri Clover Adapter

Stainless Grade 316

Features

- 150lbs Pressure Rating
- Flat spot for ease of tightening

*"No need for welding!
Save time and effort
with one-piece adapters"*

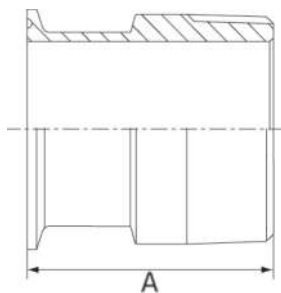

Dimensions

Unit: mm (unless stated otherwise)

Size	12.7 1/2"	19.05 3/4"	25.4 1"	31.8 1 1/4"	38.1 1 1/2"
A	54	54	57.2	57.2	57.2
Code	SWNAFER12	SWNAFER20	SWNAFER25	SWNAFER30	SWNAFER40

Size	50.8 2"	63.5 2 1/2"	76.2 3"	101.6 4"
A	58.7	71.4	76.2	81
Code	SWNAFER50	SWNAFER65	SWNAFER75	SWNAFER100

Stocked Items Non-Stocked Items