

Bossed Clamp

Stainless Grade 304

Features

- To suit stainless Outside Diameter tube or Nominal Bore pipe
- M10 threaded boss
- Includes stainless fasteners (Metric)

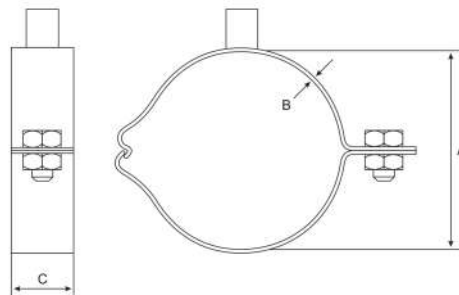

Dimensions - Imperial Tube

Unit: mm (unless stated otherwise)

Size	9.53 - 19.05 3/8" - 3/4"	25.4 1"	31.8 1 1/4"	38.1 1 1/2"	50.8 2"	63.5 2 1/2"	76.2 3"	101.6 4"	127 - 152.4 5" - 6"
A	<i>These sizes</i>	25.4	31.8	38.1	50.8	63.5	76.2	101.6	<i>These sizes</i>
B	<i>are stocked as</i>	3	3	3	3	3	3	3	<i>are stocked as</i>
C	<i>Saddles. Refer to</i>	25	25	25	25	25	25	25	<i>Saddles. Refer to</i>
Code	<i>opposite page.</i>	SBTC25	SBTC30	SBTC40	SBTC50	SBTC65	SBTC75	SBTC100	<i>opposite page.</i>

Dimensions - Metric Tube

Unit: mm (unless stated otherwise)

Size	15 - 22	28	35	42	54	76.2	88.9	108
A	<i>This size is</i>	28	35	42	54	76.2	88.9	108
B	<i>stocked as a</i>	3	3	3	3	3	3	3
C	<i>Saddle. Refer to</i>	25	25	25	25	25	25	25
Code	<i>opposite page.</i>	UBTC28	UBTC35	UBTC42	UBTC54	UBTC75	UBTC88	UBTC108

Dimensions - Nominal Bore Pipe

Unit: mm (unless stated otherwise)

Size	15NB 1/2"	20NB 3/4"	25NB 1"	32NB 1 1/4"	40NB 1 1/2"
A	<i>This size is</i>	27	33	43	48
B	<i>stocked as a</i>	3	3	3	3
C	<i>Saddle. Refer to</i>	25	25	25	25
Code	<i>opposite page.</i>	SBPC20	SBPC25	SBPC32	SBPC40

Size	50NB 2"	65NB 2 1/2"	80NB 3"	100NB 4"	125NB - 150NB 5" - 6"
A	60	73	89	115	<i>These sizes</i>
B	3	3	3	3	<i>are stocked as</i>
C	25	25	25	25	<i>Saddles. Refer to</i>
Code	SBPC50	SBPC65	SBPC80	SBPC100	<i>opposite page.</i>

