

Inline Non-Return Valve

Features

- Able to be clamped in centre of union for easy access
- Maximum pressure 145PSI / 10Bar
- Maximum working temperature 120°C (with EPDM seal)
- Spring actioned flow control
- Can be used with Tri Clover and RJT unions

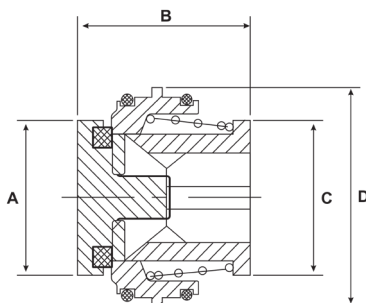

Dimensions

Unit: mm (unless stated otherwise)

Size	1 1/2" 38.1	2" 50.8	2 1/2" 63.5	3" 76.2	4" 101.6
A	27	40	52	65	89
B	30	33	35	38	42
C	27	40	52	65	89
D	38	50	63	76	101
Code	SINRV40	SINRV50	SINRV65	SINRV75	SINRV100

