

150LB Socket Weld Elbow 90°

Features

- Socket Weld Ends
- Working Pressure: 150lbs (psi) / 10bar
- Working Temperature: 250°C at 10bar
- Investment lost wax casting manufactured to ISO 9001 : 2015
- Thread ends conform to ISO 7-1 & ISO 228-1
- Mill Test Certificates (EN10201 Type 2.2) available with all sizes

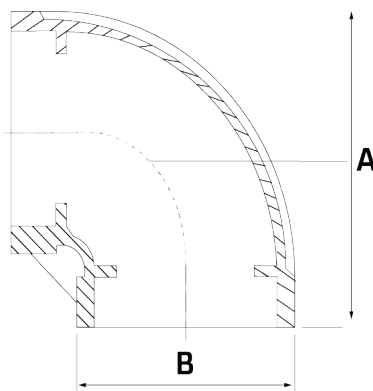

Dimensions

Unit: mm (unless stated otherwise)

Size	1/2" 15NB	3/4" 20NB	1" 25NB	1 1/4" 32NB	1 1/2" 40NB	2" 50NB	2 1/2" 65NB
A	39.5	45.5	54	66	74.5	86.5	112.5
B	26.4	29.6	41.8	50	57.6	69	90
Code	SESW1LB15#	SESW1LB20#	SESW1LB25#	SESW1LB32#	SESW1LB40#	SESW1LB50#	SESW1LB65#

Size	3" 80NB	4" 100NB
A	123.2	149
B	73.2	89.7
Code	SESW1LB80#	SESW1LB100#

