

150LB Socket Weld Mac Union

Features

- Working Pressure: 150lbs (psi) / 10bar
- Working Temperature: 250°C at 10bar
- Investment lost wax casting manufactured to ISO 9001 : 2015
- Thread ends conform to ISO 7-1 & ISO 228-1
- Mill Test Certificates (EN10201 Type 2.2) available with all sizes
- Flat Faced Union
- EPDM Gasket Included, But Can Be Sold Separately.

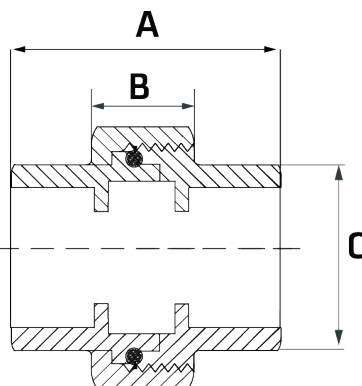

Dimensions

Unit: mm (unless stated otherwise)

Size	1/2" 15NB	3/4" 20NB	1" 25NB	1 1/4" 32NB	1 1/2" 40NB	2" 50NB	2 1/2" 65NB
A	44	49	49	60	66	69	74
B	17.3	18.8	19.3	25.9	24.6	27.5	27.8
C	27	32	38	49	56.5	69.8	81.8
Code	SMUSW1LB15#	SMUSW1LB20#	SMUSW1LB25#	SMUSW1LB32#	SMUSW1LB40#	SMUSW1LB50#	SMUSW1LB65#

Size	3" 80NB	4" 100NB
A	88	103
B	28.8	39.5
C	95.8	124.5
Code	SMUSW1LB80#	SMUSW1LB100#

