

BSP Weld Nipple

Features

- BSP Threaded Ends
- Working Pressure: 150lbs (psi) / 10bar
- Working Temperature: 250°C at 10bar
- Investment lost wax casting manufactured to ISO 9001 : 2015
- BSP thread conforms with ISO 7-1/ISO 228-1
- Male Threads are Tapered (BSPT)
- Mill Test Certificates (EN10201 Type 2.2) available with all sizes
- Butt Welds To Nominal Bore Pipe Sizes
- View Extended Weld Nipples for more length options.

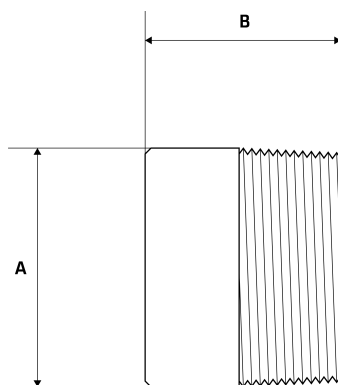

Dimensions

Unit: mm (unless stated otherwise)

Size	1/4" 8NB	3/8" 10NB	1/2" 15NB	3/4" 20NB	1" 25NB	1 1/4" 32NB	1 1/2" 40NB
A	14	17	21.5	26.8	34	42.7	48.8
B	30	30	35	40	40	50	50
Code	SWN08	SWN10	SWN15	SWN20	SWN25	SWN32	SWN40

Size	2" 50NB	2 1/2" 65NB	3" 80NB	4" 100NB	5" 150NB
A	61	77.5	90	115.8	166
B	50	60	70	80	100
Code	SWN50	SWN65	SWN80	SWN100	SWN150

