

BSP Hex Nipple

Features

- BSP Threaded Ends
- Working Pressure: 150lbs (psi) / 10bar
- Working Temperature: 250°C at 10bar
- Investment lost wax casting manufactured to ISO 9001 : 2015
- BSP thread conforms with ISO 7-1/ISO 228-1
- Male Threads are Tapered (BSPT)
- Mill Test Certificates (EN10201 Type 2.2) available with all sizes

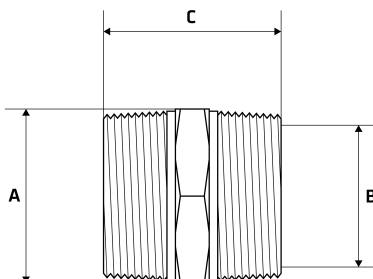

Dimensions

Unit: mm (unless stated otherwise)

Size	1/8" 6NB	1/4" 8NB	3/8" 10NB	1/2" 15NB	3/4" 20NB	1" 25NB	1 1/4" 32NB
A	12.9	14.5	17.8	22.8	27.5	36.7	44.6
B	5	6.9	10.2	14.1	19.5	24.4	32.8
C	26	25	33	39	39	48	51.4
Code	SHN06	SHN08	SHN10	SHN15	SHN20	SHN25	SHN32

Size	1 1/2" 40NB	2" 50NB	2 1/2" 65NB	3" 80NB	4" 100NB
A	49	61.7	77.6	90	120
B	38.7	50.3	65.2	77.2	101
C	49.5	63.4	71	76	73
Code	SHN40	SHN50	SHN65	SHN80	SHN100

