

Schedule 10S Pipe Eccentric Reducer

Features

- Schedule 10S
- Standard ASME B16.9

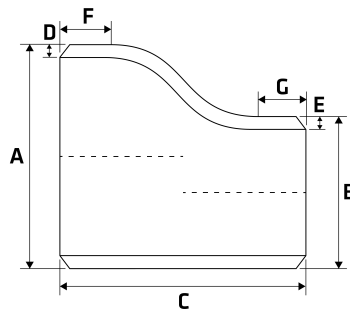

Dimensions

Unit: mm (unless stated otherwise)

Size	3/4"x1/2" 20NBx15NB	1"x1/2" 25NBx15NB	1"x3/4" 25NBx20NB	1 1/4"x1" 32NBx25NB	1 1/2"x3/4" 40NBx20NB	1 1/2"x1" 40NBx25NB	1 1/2"x1 1/4" 40NBx32NB
A	26.7	33.4	33.4	42.2	48.3	48.3	48.3
B	21.3	21.3	26.7	33.4	26.7	33.4	42.2
C	38.0	50.8	50.8	50.8	63.5	63.5	63.5
D	2.11	2.77	2.77	2.77	2.77	2.77	2.77
E	2.11	2.11	2.11	2.77	2.11	2.77	2.77
F	8	8	8	10	15	15	15
G	8	8	8	10	15	15	15
Code	SPER2015S10	SPER2515S10	SPER2520S10	SPER3225S10	SPER4020S10	SPER4025S10	SPER4032S10

Size	2"x1" 50NBx25NB	2"x1 1/2" 50NBx40NB	2 1/2"x2" 65NBx50NB	3"x1 1/2" 80NBx40NB	3"x2" 80NBx50NB	3"x2 1/2" 80NBx65NB	4"x2" 100NBx50NB
A	60.3	60.3	73	88.9	88.9	88.9	114.3
B	33.4	48.3	60.3	48.3	60.3	73	60.3
C	76.2	76.2	88.9	88.9	88.9	88.9	101.6
D	2.77	2.77	3.05	3.05	3.05	3.05	3.05
E	2.77	2.77	2.77	2.77	2.77	3.05	2.77
F	15	15	15	15	15	15	15
G	15	15	15	15	15	15	15
Code	SPER5025S10	SPER5040S10	SPER6550S10	SPER8040S10	SPER8050S10	SPER8065S10	SPER10050S10



Size	4"x2 1/2" 100NBx65NB	4"x3" 100NBx80NB	5"x3" 125NBx80NB	5"x4" 125NBx100NB	6"x3" 150NBx80NB	6"x4" 150NBx100NB	6"x5" 150NBx125NB
A	114.3	114.3	141.3	141.3	168.3	168.3	168.3
B	73	88.9	88.9	114.3	88.9	114.3	141.4
C	101.6	101.6	127	127	139.7	140	139.7
D	3.05	3.05	3.4	3.4	3.4	3.4	3.4
E	3.05	3.05	3.05	3.05	3.05	3.05	3.4
F	15	15	18	18	25	25	25
G	15	15	18	18	25	25	25
Code	SPER10065S10	SPER10080S10	SPER12580S10	SPER125100S10	SPER15080S10	SPER150100S10	SPER150125S10

Size	8"x4" 200NBx100NB	8"x6" 200NBx150NB	10"x6" 250NBx150NB	10"x8" 250NBx200NB	12"x6" 300NBx150NB	12"x8" 300NBx200NB	12"x10" 300NBx250NB
A	219.1	219.1	273	273	323.8	323.8	323.8
B	114.3	168.3	168.3	219.1	168.3	219.1	273
C	152.4	152.4	177.8	177.8	203.2	203.2	203.2
D	3.76	3.76	4.19	4.19	4.57	4.57	4.57
E	3.05	3.4	3.4	3.76	3.4	3.76	4.19
F	25	25		17			19
G	25	25		14			17
Code	SPER200100S10	SPER200150S10	SPER250150S10	SPER250200S10	SPER300150S10	SPER300200S10	SPER300250S10

Size	14"x10" 350NBx250NB	14"x12" 350NBx300NB	16"x12" 400NBx300NB	16"x14" 400NBx350NB
A	335.6	355.6	406.4	406.4
B	273	323.8	323.8	355.6
C	330	330	356	356
D	4.78	4.78	4.78	4.78
E	4.19	4.57	4.57	4.78
F		21		22
G		19		21
Code	SPER350250S10	SPER350300S10	SPER400300S10	SPER400350S10

