

Schedule 40S Pipe Eccentric Reducer

Features

- Schedule 40S
- Standard ASME B16.9

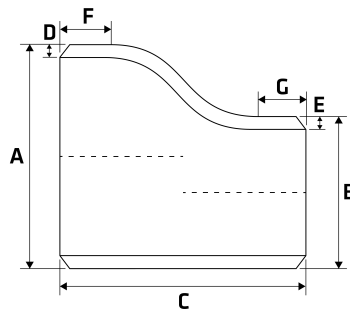

Dimensions

Unit: mm (unless stated otherwise)

Size	3/4"x1/2" 20NBx15NB	1"x1/2" 25NBx15NB	1"x3/4" 25NBx20NB	1 1/4"x1" 32NBx25NB	1 1/2"x3/4" 40NBx20NB	1 1/2"x1" 40NBx25NB	1 1/2"x1 1/4" 40NBx32NB
A	26.7	33.4	33.4	42.2	48.3	48.3	48.3
B	21.3	21.3	26.7	33.4	26.7	33.4	42.2
C	38.0	50.8	50.8	50.8	63.5	63.5	63.5
D	2.87	3.38	3.38	3.56	3.68	3.68	3.68
E	2.77	2.77	2.87	3.38	2.87	3.38	3.56
F	8	8	8	10	15	15	15
G	8	8	8	10	15	15	15
Code	SPER2015S40	SPER2515S40	SPER2520S40	SPER3225S40	SPER4020S40	SPER4025S40	SPER4032S40

Size	2"x1" 50NBx25NB	2"x1 1/2" 50NBx40NB	2 1/2"x2" 65NBx50NB	3"x1 1/2" 80NBx40NB	3"x2" 80NBx50NB	3"x2 1/2" 80NBx65NB	4"x2" 100NBx50NB
A	60.3	60.3	73	88.9	88.9	88.9	114.3
B	33.4	48.3	60.3	48.3	60.3	73	60.3
C	76.2	76.2	88.9	88.9	88.9	88.9	101.6
D	3.91	3.91	5.16	5.49	5.49	5.49	6.02
E	3.38	3.68	3.91	3.68	3.91	5.16	3.91
F	15	15	15	15	15	15	15
G	15	15	15	15	15	15	15
Code	SPER5025S40	SPER5040S40	SPER6550S40	SPER8040S40	SPER8050S40	SPER8065S40	SPER10050S40



Size	4"x2 1/2" 100NBx65NB	4"x3" 100NBx80NB	5"x3" 125NBx80NB	5"x4" 125NBx100NB	6"x3" 150NBx80NB	6"x4" 150NBx100NB	6"x5" 150NBx125NB
A	114.3	114.3	141.3	141.3	168.3	168.3	168.3
B	73	88.9	88.9	114.3	88.9	114.3	141.4
C	101.6	101.6	127	127	139.7	139.7	139.7
D	6.02	6.02	6.55	6.55	7.11	7.11	7.11
E	5.16	5.49	5.49	6.02	5.49	6.02	6.55
F	15	15	18	18	25	25	25
G	15	15	18	18	25	25	25
Code	SPER10065S40	SPER10080S40	SPER12580S40	SPER125100S40	SPER15080S40	SPER150100S40	SPER150125S40

