

# BSP Female Hosetail

## Features

- BSP Threaded Ends
- Working Pressure: 150lbs (psi) / 10bar
- Working Temperature: 250°C at 10bar
- Investment lost wax casting manufactured to ISO 9001 : 2015
- BSP thread conforms with ISO 7-1/ISO 228-1
- Female Threads are Parallel (BSPP)
- Mill Test Certificates (EN10201 Type 2.2) available with all sizes

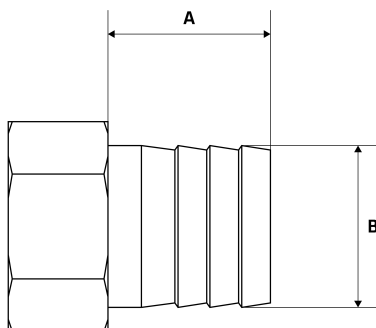

## Dimensions

Unit: mm (unless stated otherwise)

Size	1/4"x7 7x8NB	1/4"x9.5 9.5x8NB	3/8" 9.5x10NB	1/2" 12.7x15NB	3/4" 19x20NB	1" 25.4x25NB	1 1/4" 31.8x32NB
<b>A</b>	24.5	24.5	22.5	26	33	37.1	38
<b>B</b>	9	9	9.5	12.7	19.5	25.4	31.8
<b>Code</b>	SFH08	SFH08-9	SFH10	SFH15	SFH20	SFH25	SFH32

Size	1 1/2" 38.1x40NB	2" 50.8x50NB
<b>A</b>	46.5	49
<b>B</b>	38.1	51.4
<b>Code</b>	SFH40	SFH50

