

Tri Clover Polycarbonate Sight Glass - Long

Features

- Tri Clover ferrule connections
- Sight Glass Body is 316, however the Fasteners are 304
- Comes standard with polycarbonate viewing tube
- Polycarbonate maximum temperature 80°C
- No pressure rating is available from the manufacturer, we estimate maximum pressure rating of 2 bar
- Replacement tube lens available
- Polycarbonate is not suitable for Caustic and other CIP Chemicals

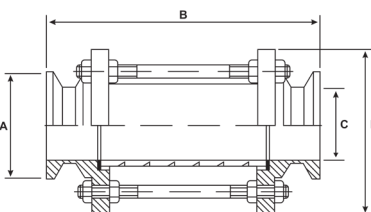

Dimensions

Unit: mm (unless stated otherwise)

Size	1" 25.4	1 1/2" 38.1	2" 50.8	2 1/2" 63.5	3" 76.2	4" 101.6
A	50.5	50.5	64	77.5	91	119
B	190	190	190	190	190	190
C	23	34.8	47	60	72.9	97.4
D	54	75	85	95	110	145
Code	SSGFER25L	SSGFER40L	SSGFER50L	SSGFER65L	SSGFER75L	SSGFER100L

