

BSP Weld Nipple Adapter

Features

- BSP Threaded End
- Working Pressure: 150lbs (psi) / 10bar
- Working Temperature: 250°C at 10bar
- Butt Welds To Outside Diameter Tube Sizes
- BSP thread conforms with ISO 7-1/ISO 228-1
- Male Threads are Tapered (BSPT)
- Flat Spot For Ease Of Tightening

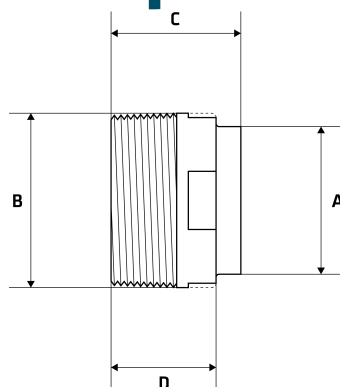

Dimensions

Unit: mm (unless stated otherwise)

Size	1/2" 12.7x15NB	3/4" 19.05x20NB	1" 25.4x25NB	1 1/4" 31.8x32NB	1 1/2" 38.1x40NB	2" 50.8x50NB	2 1/2" 63.5x65NB
A	12.7	19.05	25.4	31.8	38.1	50.8	63.5
B	21.2	21.2	33.5	41.5	47.9	60	75.2
C	41.3	41.3	44.5	44.5	44.5	46	58
D	35	29.4	35.7	35.7	35.7	36	48
Code	SWNA15	SWNA20	SWNA25	SWNA32	SWNA40	SWNA50	SWNA65

Size	3" 76.2x80NB	4" 101.6x100NB
A	76.2	101.6
B	88.7	113.6
C	63.7	65.2
D	54.1	55.7
Code	SWNA80	SWNA100

