

Round Tube Dome Cap

Features

- Perfect for use on handrail
- 2B Finish

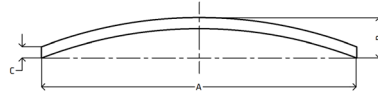

Dimensions

Unit: mm (unless stated otherwise)

Size	1" 25.4	1 1/4" 31.8	1 1/2" 38.1	2" 50.8	2 1/2" 63.5	3" 76.2	4" 101.6
A	25.4	31.8	38.1	50.8	63.5	76.2	101.6
B	4.4	5.0	5.2	6.5	7.3	8.5	8.0
C	1.8	1.8	1.8	1.8	1.8	1.8	1.8
Thickness	1.8	1.8	1.8	1.8	1.8	1.8	1.8
Code	STDC25	STDC30	STDC40	STDC50	STDC65	STDC75	STDC100

Size	5" 127.0	6" 152.4
A	127.0	152.4
B	11.0	11.4
C	2.0	2.0
Thickness	2.0	2.0
Code	STDC125	STDC150

